

30-82



KENT A. HEALY ScD. PE
Civil Engineering
1 Farms End Road
P. O. Box 128
West Tisbury, MA 02575
(508 693 6736)

November 17, 2004

Board of Health
Chilmark, Mass.

Dear Members:

On November 10 and 15, I made a preliminary inspection of the waste water treatment system serving the Menemsha School building on assessors parcel 26-82, State Road, Chilmark, Mass. The system consists of a 1000 gallon septic tank, a 1000 gallon pump tank and a leaching bed, all as shown on my 6/25/87 sketch of the 4/22/87 construction. The septic tank and pump tank are in good condition. I exposed the D-Box and realigned the cover that had been shifted. There was no evidence of the leaching bed being flooded. A complete assessment of the system would require monitoring the water use, checking the pumps, and observing the liquid level in the leaching bed. The leaching bed could be reconstructed on the same site to provide additional capacity if needed.

Kent A. Healy
PE Mass. #28498

received

1/17/04

PLAN 1"=40'

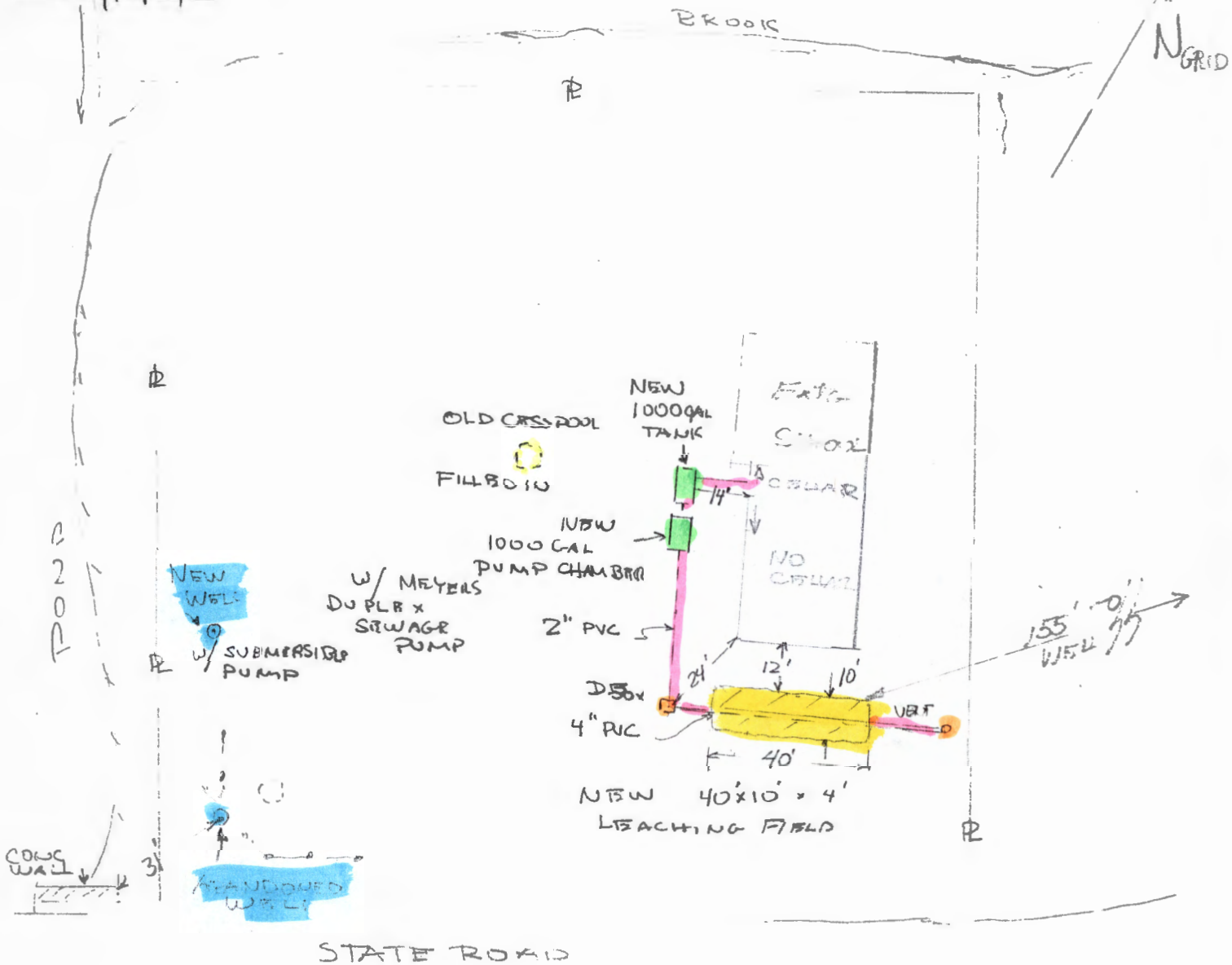

X-SECTION OF LEACHING FIELD

1"=5'

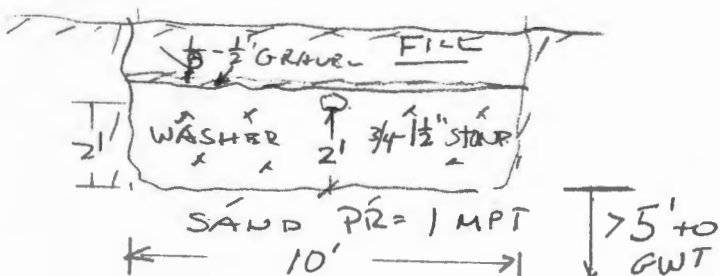

Kent A. Healy
6/25/07

NEW WASTE WATER DISPOSAL SYSTEM AS BUILT 4/22/07
FOR CHILMARK SCHOOL